

User Instructions

- ◆ Please read this operation guide and safety regulations before your operation. Improper operations which don't comply with this manual maybe cause damage to the device or influence on the results.
- ◆ Please do not use the device in inflammable and explosive environment.
- ◆ Junked device should not processed as household garbages. Please deal with it according to the local laws regulations.
- ◆ Any quality issues or any questions on the device, please contact your local distributors of manufacturer at once.

Professional to Premium Product
Premium Product to Reliable Brand

OVERVIEW

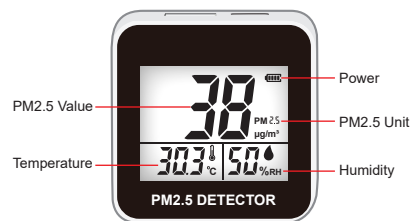
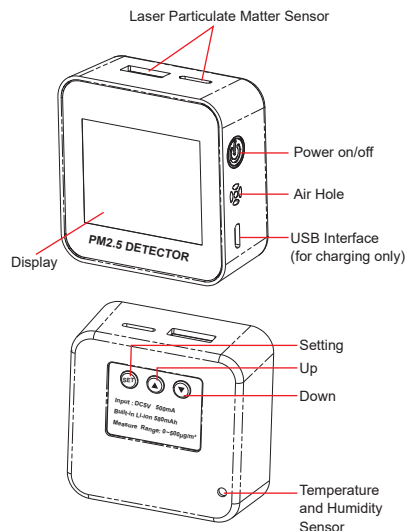

Power on/off

Short press to turn on the device. The device start to monitor PM2.5 after 10s. Long press to turn off the device.

Alarm

1. When the detected result over the setting value, the result will blink in red to alarm.
2. Short press to set the alarm. Short press or to adjust the value when the value is twinkling. Long press or to adjust more quickly.

Short press to save the setting. Or short press to cancel the setting and return to the main screen.

Battery Charging

The device ex-factory with USB connector. A power adapter with DC 5V, >500mA is suggested for charging.

Packing List

NO.	CONTENT	QTY	REMARKS
1	PM2.5 Detector	1	
2	USB Connector	1	
3	User Manual	1	

PM2.5 Detector

User's Manual



Technical Data

ITEM	SPEC
PM2.5 Measuring Range	0 ~ 500 µg/m³
Single Response Time	<1s
Integrated Response Time	<10s
Resolution Rate	1 µg/m³
Counting Efficiency of Particulate Matter	50% @ 0.3 µm 98% @ ≥ 0.5 µm
Mass Concentration Consistency of Particulate Matter	±10% @ 100 ~ 500 µg/m³ ±10 µg/m³ @ 0 ~ 100 µg/m³
Temperature Measuring Range	-10.0 ~ 50.0 °C
Temperature Accuracy	±1.0 °C
Humidity Measuring Range	0% ~ 99% RH
Humidity Accuracy	±10% RH
PM2.5 Sensor	PLANTOWER Laser Particulate Matter Sensor
Battery Life for Once Charging	>4.5h
Auto Power off	30minutes (The device cannot be power off automatically while charging time.)
Charging	DC 5V, 500mA, USB Connector
Battery	Li-Ion 580mAh
Working Temperature	-10.0 °C ~ 50.0 °C, 0% ~ 99% RH
Net Weight	86g
Dimension	60x60x26mm

Notes: Because Batteries will be warmed while charging, it will effect the temperature result, which is normal.

Appendix

Grade of Air Quality	Average Value of PM2.5 in 24hours
Great	0~35µg/m³
Good	35~75µg/m³
Mildly Polluted	75~115µg/m³
Moderately Polluted	115~150µg/m³
Seriously Polluted	150~250µg/m³
Severely Polluted	>250µg/m³

Note: Bluetooth and WIFI will be only available for future models. This model doesn't get these functions.

封面

5

6

封底

4色、8P折页说明书

尺寸：80*57mm